



4 Ribbonwood Close Largs, NSW



4



2



2

## Beautifully constructed family home in Largs

Nestled on a 579sqm block with a half render/ half brick facade, this 4 bedroom home offers outstanding features for those looking to seize the opportunity to secure a rare find in this esteemed community. From a chef's kitchen to a seamless flow between the living, dining and lounge ? this home is family ready. 800m to local school, only 6km to both Maitland and Morpeth.

- Half render/ half brick modern classic facade on a 579sqm block
- Kitchen with gas cook top, dishwasher, breakfast bar & large corner pantry
- Naturally airy living/dining with s/s air & glass sliders to alfresco area
- Separate lounge at the front of the residence with front door and entrance foyer

**Price:** \$700,000

**Matthew Clarkson**

0456 791 524

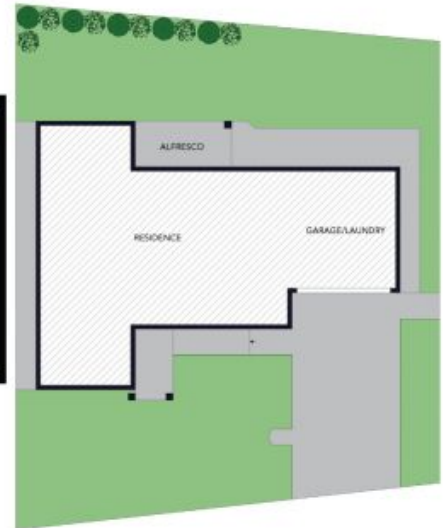

SITE PLAN



The site plan and floor plan are not to scale; measurements are indicative and in metres. Bushes and trees are placed for illustration purposes. Plans should not be relied on. Interested parties should make and rely on their own enquiries. All other information provided has been collected from reliable sources but cannot be guaranteed for accuracy.